

2025 CARS-MISSION ROAD CITY COUNCIL UPDATE

FEBRUARY 19TH, 2024 COUNCIL WORKSHOP



AGENDA



- Introductions
- Existing Conditions
- Project Status
- Proposed Major Changes



DONNIE SCHARFF
PUBLIC WORKS DIRECTOR
ROELAND PARK



DAN MILLER
CIVIL DESIGN GROUP LEADER
LAMP RYNEARSON



GREG VAN PATTEN
PROJECT MANAGER
LAMP RYNEARSON



TROY MONTAGUE
PROJECT ENGINEER
LAMP RYNEARSON



JOHN SULLIVAN
PUBLIC WORKS DIRECTOR
WESTWOOD



EXISTING CONDITIONS (W 47TH AVE TO W 53RD ST.)



- Approximately 34' B-B (30' PVMT) residential collector
- East half of road in City of Westwood, west half in City of Roeland Park
- On street parking allowed on west side of Mission Road
- Drop off lane in front of St. Agnes Catholic School
- Existing sidewalk east side of Mission
- Existing sidewalk runs on west side of Mission Road from St Agnes Property to 4718 Mission Road
- Every street lighting on east side of road

PROJECT STATUS

- Interlocal agreement between City of Roeland Park and City of Westwood executed
- Lamp Rynearson hired to do preliminary design work and submit CARS estimate
- Preliminary design underway, survey complete
- Coordination meetings with Roeland Park, Westwood, and Fairway
- Johnson County CARS application due March 8, 2024
- Final design spring 2024, easement acquisition summer/fall 2024
- Bid project end of 2024, construction 2025

MAJOR PROPOSED CHANGES - BIKE LANES

- Mission Road included in MARC Bike Plan, Roeland Park Bike Plan, and Westwood Bike Plan
- Proposed 5-foot bicycle lanes with 10-foot driving lanes marked and signed
- Road width can accommodate bike lanes only with eliminating on street parking
- Proposed bike lanes start at W 47th Street and continue to St. Agnes School
- Share the road markings and signing south end of project



CHALLENGES WITH ELIMINATING ON STREET PARKING

- Currently 13 Roeland Park properties have only a single parking driveway
 - 9 properties (4760, 4808, 4824, 4812, 4826, 4900, 4906, 4916, 4930, 5036 Mission Road) can have an 8'-10' wide and 20' deep pad added
 - Width of pad varies depending on property lines
 - 4 properties (4724, 4728, 4734, 4770 Mission Road) cannot have additional parking added because of basement garages and retaining walls
- All properties would require temporary construction easements and could have landscaping adjustments
- Additional estimated cost for above work = \$98,800

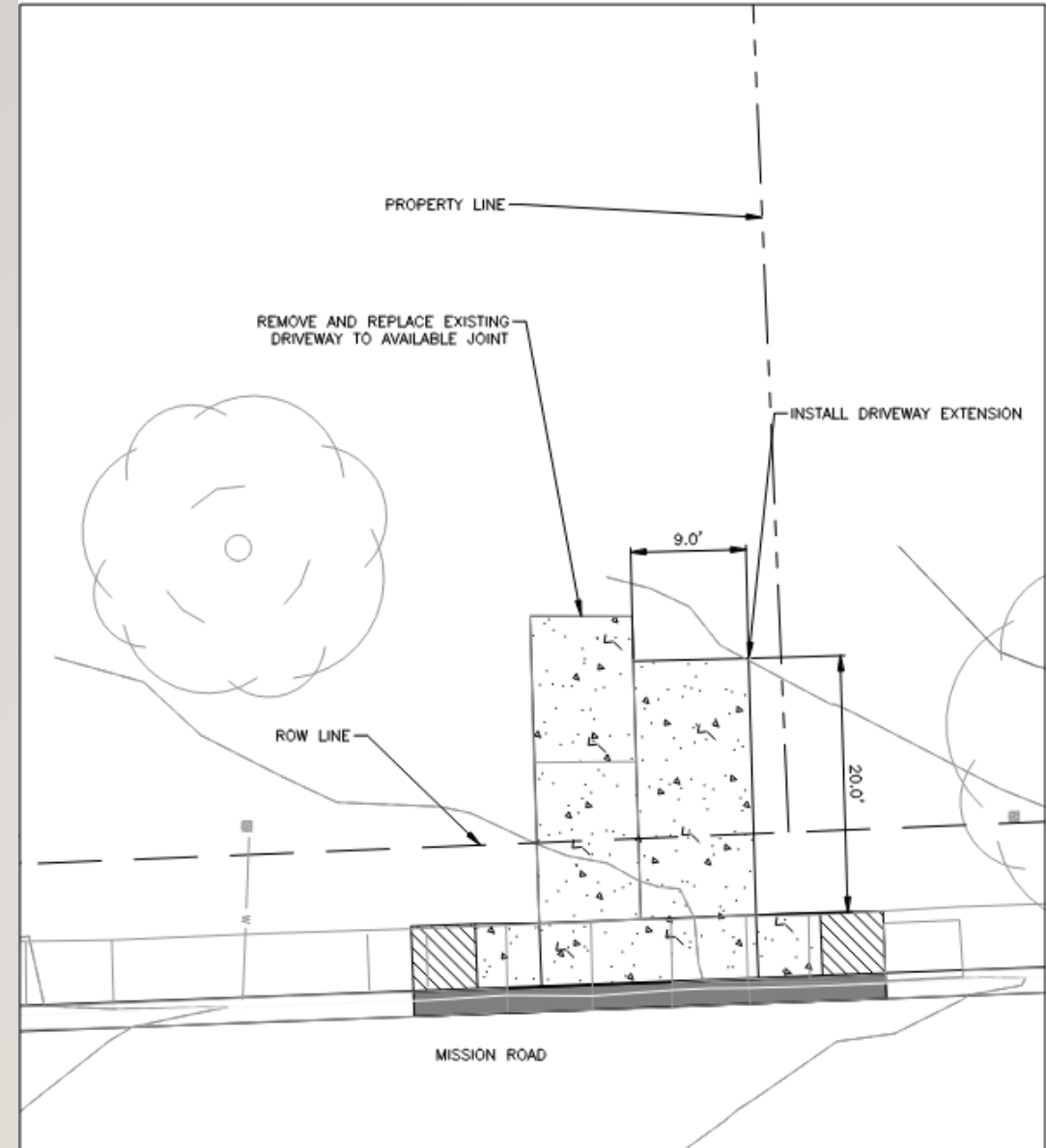

PROPOSED CHANGE: STREET LIGHTING

- Current street lighting is cobra heads on Evergy power poles on east side of Mission Road
- Goal is to remove lighting from Evergy poles and construct City owned infrastructure
- Challenges constructing city system
 - East side has storm drainage running near the back of curb (power pole foundations would not be able to go deep enough), and overhead power lines would conflict with the poles
 - West side has limited right-of-way on south end, which would require easements
- Current proposal is to have poles located along the west side of Mission Road behind sidewalk
 - Current lighting design is 30' tall cobra heads, black finish
 - Maintenance shared between both cities (maintenance agreement)
 - Some tree trimming will be necessary on the west side
 - Design will illuminate Mission Road and the pedestrian sidewalks (no pedestrian specific luminaires currently included in design)



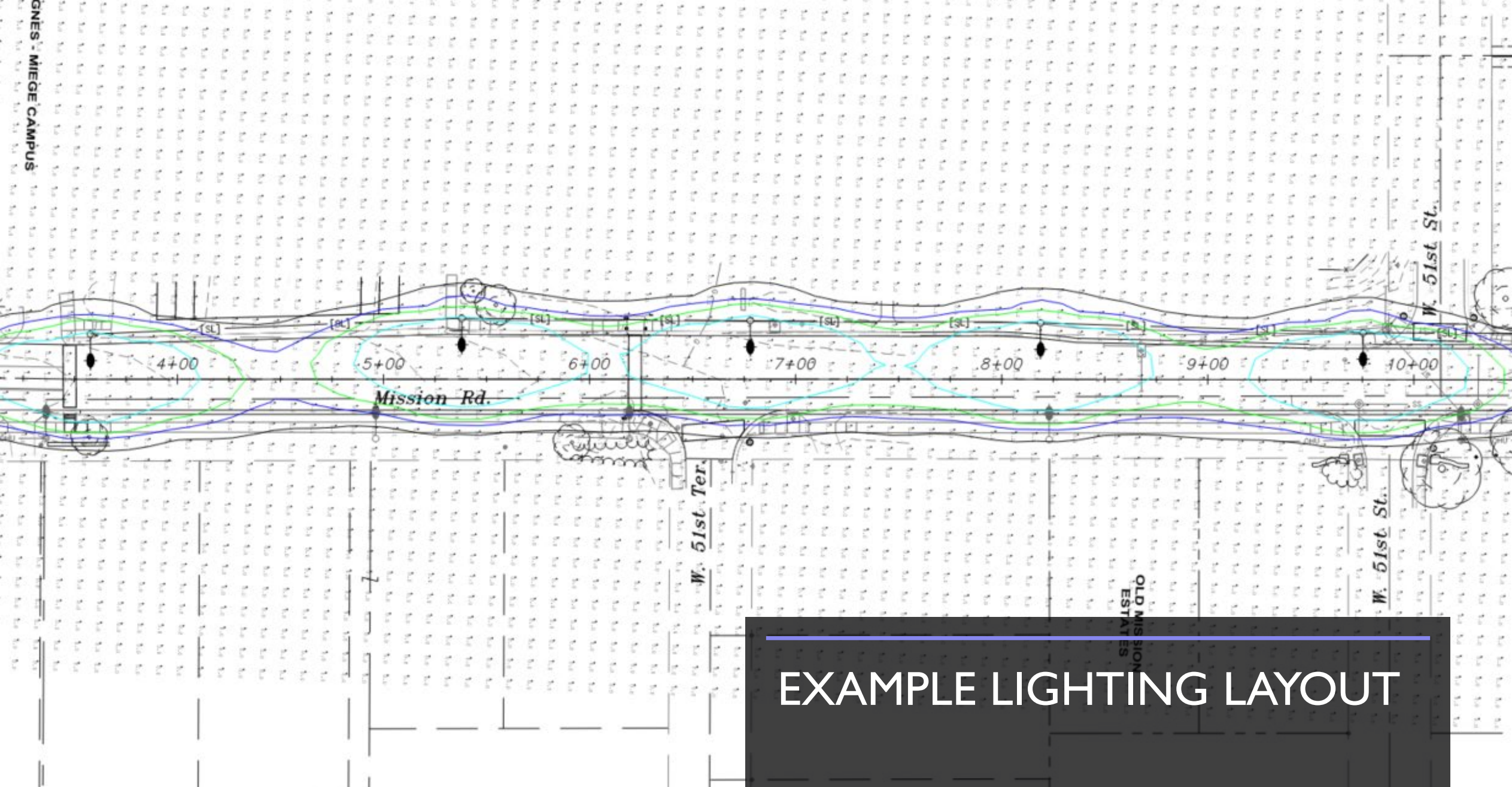

EXAMPLE LIGHTING LAYOUT

PROPOSED CHANGE: ST. AGNES PARKING LOT

- Currently the St. Agnes parking lot does not have concrete sidewalk
 - Proposing to add typical curb through the property, and add sidewalk behind curb including ADA compliant crossings
- Sidewalk is proposed to be added along the northwest end of 53rd Street and Mission Road intersection
- Easements and Right-of-way required

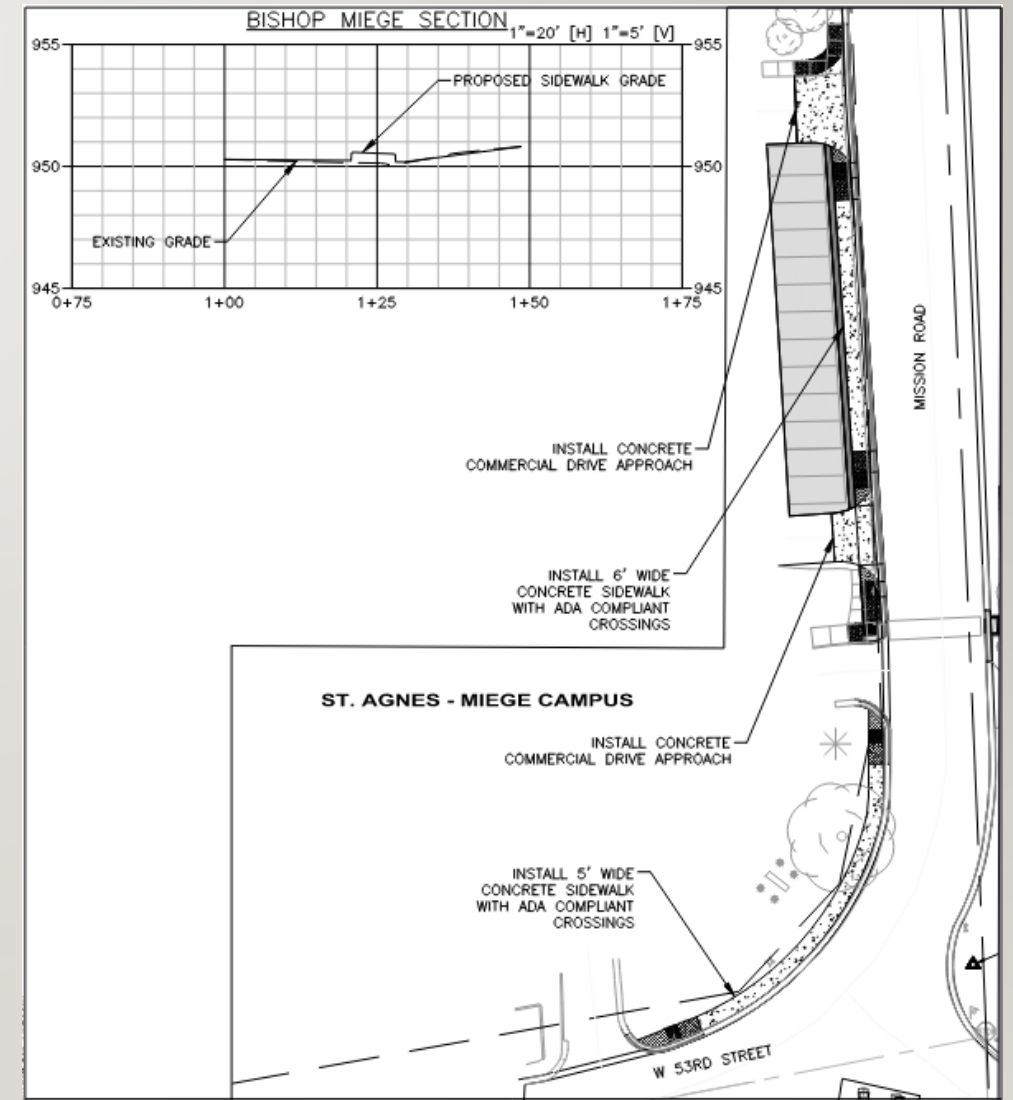

PROPOSED CHANGE: GEOMETRIC IMPROVEMENTS AT MISSION ROAD AND W 53RD STREET

- Currently northbound lane on Mission Road is very narrow
 - Proposing to widen Mission Road to W 53rd St. Radius (partially in Fairway)
- Proposing to add a median near W 53rd Street and Mission Road intersection on East side
 - Would help eliminate southbound Mission Road traffic from crossing lane lines when entering W 53rd Street and Chadwick Street

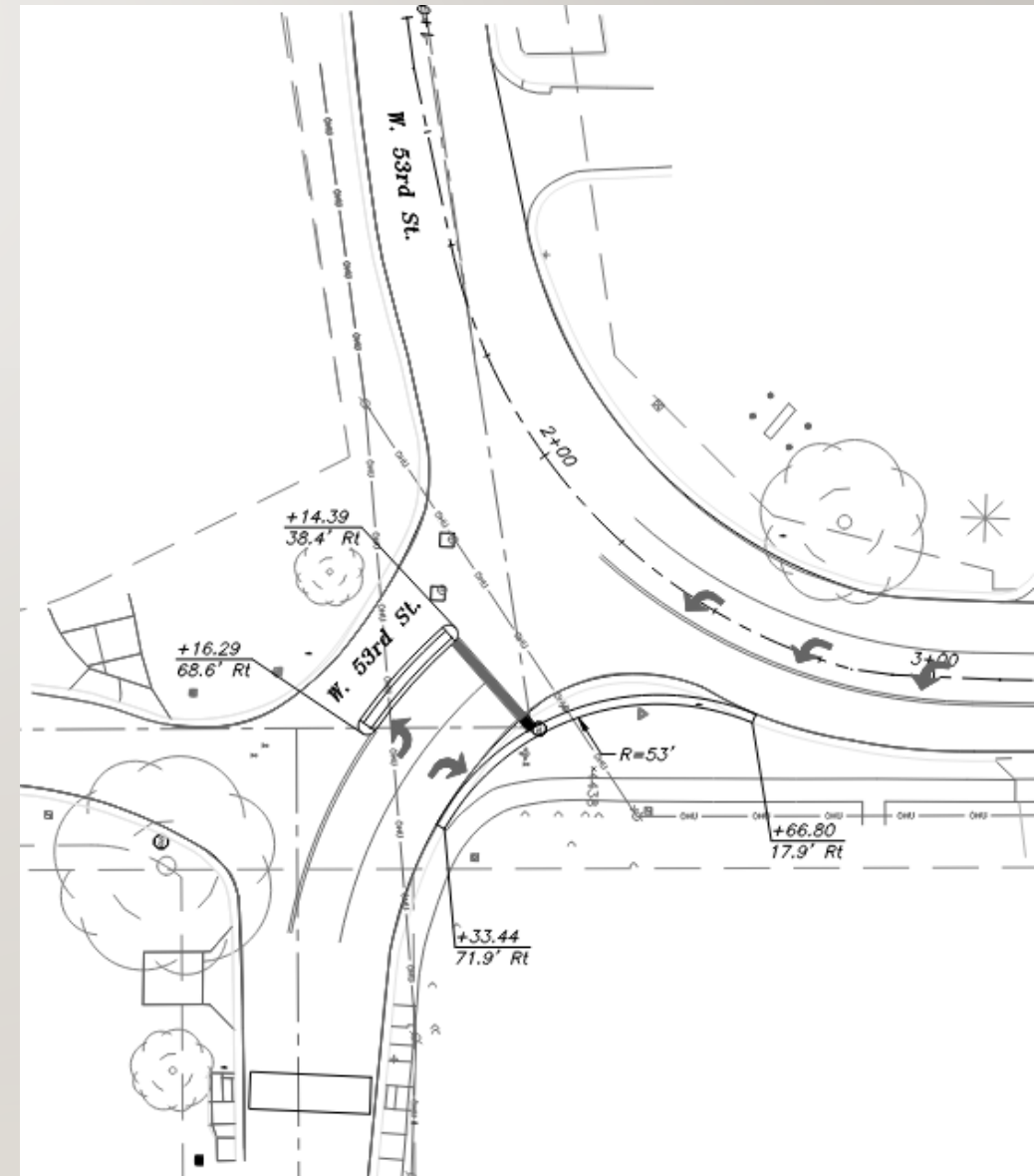

THANK YOU

QUESTIONS?

